

Article datasheet

Countersunk Screw ISO2009 M2x4 A2 Plain Stainless Steel Slotted

Article-No.: 001.11.108

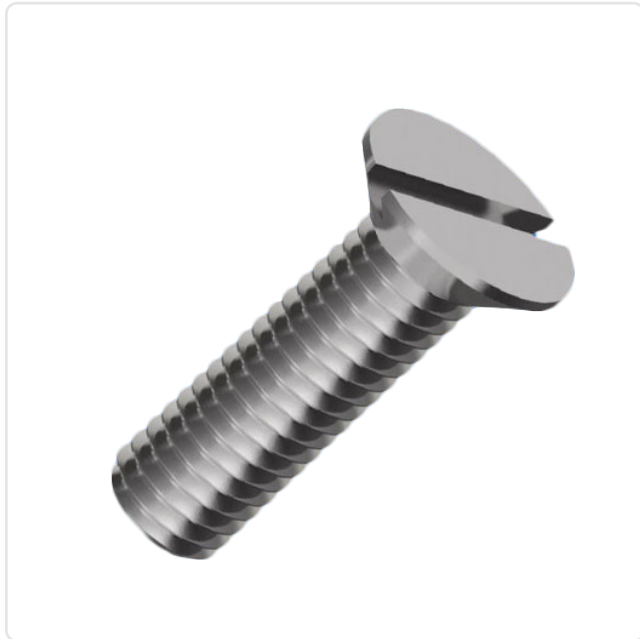
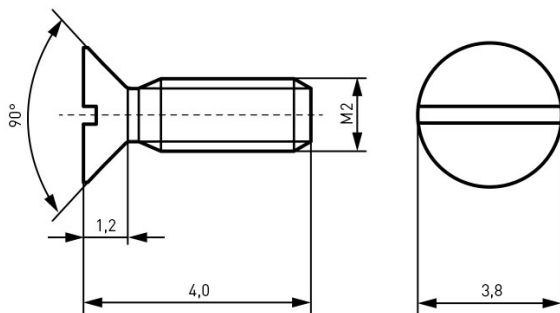

Image may be similar

| | |
|---------------------|-------------------------------|
| DIN/ISO: | DIN963 / ISO2009 |
| Drive Type: | Slotted |
| Finish: | Plain |
| Head Diameter [mm]: | 3.8 |
| Head Height [mm]: | 1.2 |
| Head Shape: | Countersunk Head |
| Length [mm]: | 4 |
| Material: | Stainless Steel AISI 304 / A2 |
| Material Group: | Stahl rostfrei |
| Thread Size: | M2 |
| Weight: | 0.15g |
| Conformities: | |



You can find all
information on the web on
our article detail page



Would you like individual advice?

We look forward to your email to products@ettinger.de.

Subject to change and errors.