

Article datasheet

Self-Clinching Stud M4x10.0 Tin-Plated Phosphor Bronze

Article-No.: 004.67.455



Image may be similar

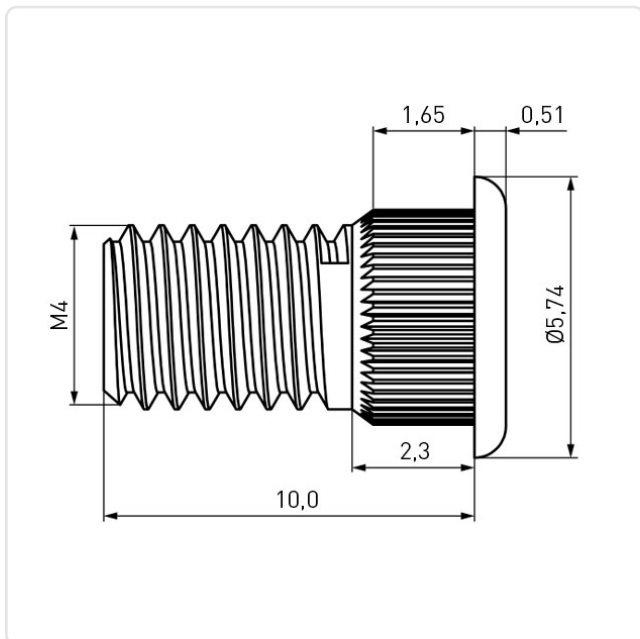

Area of Application:	For Plastics
Finish:	Tin-Plated
Head Diameter [mm]:	5.74
Length [mm]:	10
Material:	Phosphor Bronze
Material Group:	Phosphor Bronze
Minimum Edge Distance [mm]:	4.1
Panel Hole Ø [mm]:	4.2
Panel Thickness [mm]:	1,5
Thread Size:	M4
Weight:	1.06g
Conformities:	



You can find all
information on the web on
our article detail page

Would you like individual advice?

We look forward to your email to products@ettinger.de.

Subject to change and errors.