

Article datasheet

Countersunk Screw M4x12 Polyamide 6 natural slotted

Article-No.: 001.46.0310

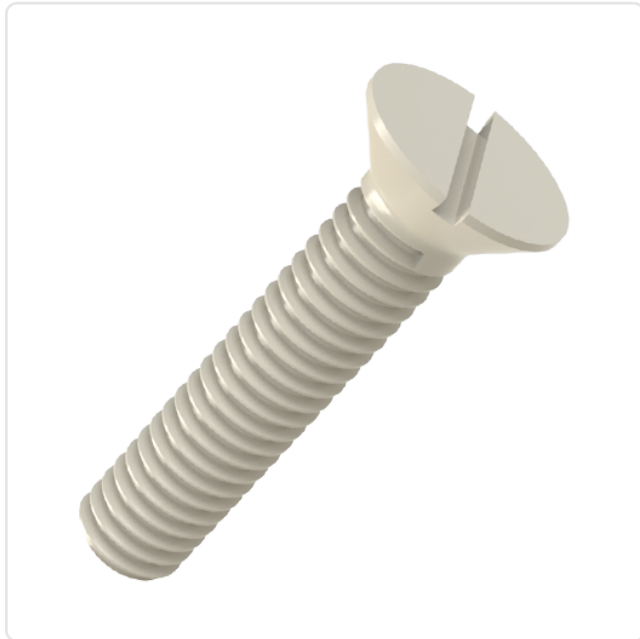

Image may be similar

Color:	Natural
Drive Type:	Slotted
Head Diameter [mm]:	9.4
Head Height [mm]:	3.7
Head Shape:	Countersunk Head
Length [mm]:	12
Material:	PA 6.0
Material Group:	Plastic
Thread Size:	M4
Weight:	0.196g
Conformities:	



You can find all
information on the web on
our article detail page

Would you like individual advice?

We look forward to your email to products@ettinger.de.

Subject to change and errors.

