

Data Sheet

## Cut-Out Cover for D-Sub 9-pole Metal Housing for EMC Application

Part No.: 076.76.255



Material :	Steel
Mounting Hole [mm] :	3,2
Special Features :	Size and Form are as D-Sub Housings
Material Group :	Steel
Width [mm] :	53
Model :	D-Sub
Weight per 100 pcs :	540 g
Customs tariff number :	85472000
Conformities :	



Image for illustrative purposes only.

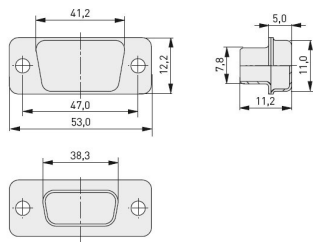

All information is available online on our detail product page!

Looking for some advice for your specific situation?  
If so, please don't hesitate to e-mail us at [products@ettinger.de](mailto:products@ettinger.de)

Subject to changes and errors.